



REMAINS LIGHTING COMPANY

CAN EXTERIOR WALL DOWNLIGHT

COMMUNE COLLECTION

A solid brass exterior sconce handcrafted to order in solid heavy, brass, with a simple cylindrical body, connected to a coped round arm and backplate with slotted countersunk screws.

DIMENSIONS

Overall: 10" h. x 5" w. x 7-1/8" d.

Backplate: 5" diameter

Shade: 4" diameter

APPLICATION

UL listed for use in dry, damp, or wet environments.

LAMPING

Single Edison socket, maximum 100 watts

Also available with GU24 sockets

JUNCTION BOX

4" x 4" junction box recommended

OPTIONS

Additional finishes available upon request.

Contact us to learn more about customization options.

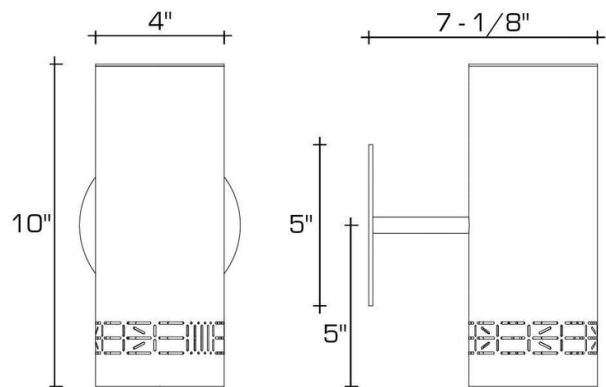

AVAILABLE FINISHES

\$1360 Polished Brass

\$1515 Dark Waxed Bronze, Polished Nickel