



REMAINS LIGHTING COMPANY

## THOMASTON STATION EXTERIOR WALL LANTERN LARGE

### SCOFIELD LIGHTING COLLECTION

A four sided copper wall lantern with mirrored curved roof and bottom details. This stately version of an 18th century French railroad station lantern offers a transitional style appropriate for both period and modern exteriors. Designed and manufactured by Scofield Lighting.

### DIMENSIONS

Overall: 21-1/4" h. x 12" w. x 9-1/4" d.

### APPLICATION

UL listed for use in dry, damp, or wet environments.

### LAMPING

Single Edison socket, maximum 100 watts  
Also available with 2 Candelabra sockets  
B11 Edison torpedo bulb recommended

### OPTIONS

Download our Finish Guide to view standard product options.

Candelabra cluster lamping available.

Alternate reflector options available.

Contact us to learn more about customization options.

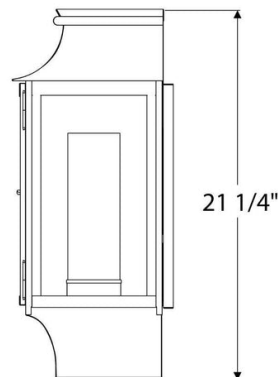
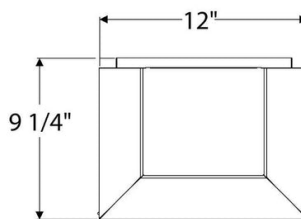

### AVAILABLE FINISHES

\$2245 Natural Copper

\$2565 Black Lacquer, Bronze Lacquer, Bronzed Copper

\$2755 Brushed Bronzed Copper, Oxidized Copper